

A ... Trinity Hall and Carlson 111

Complete **BY**:

7:00 AM ■■■

****Be sure to extend onto sidewalk which will be plowed****

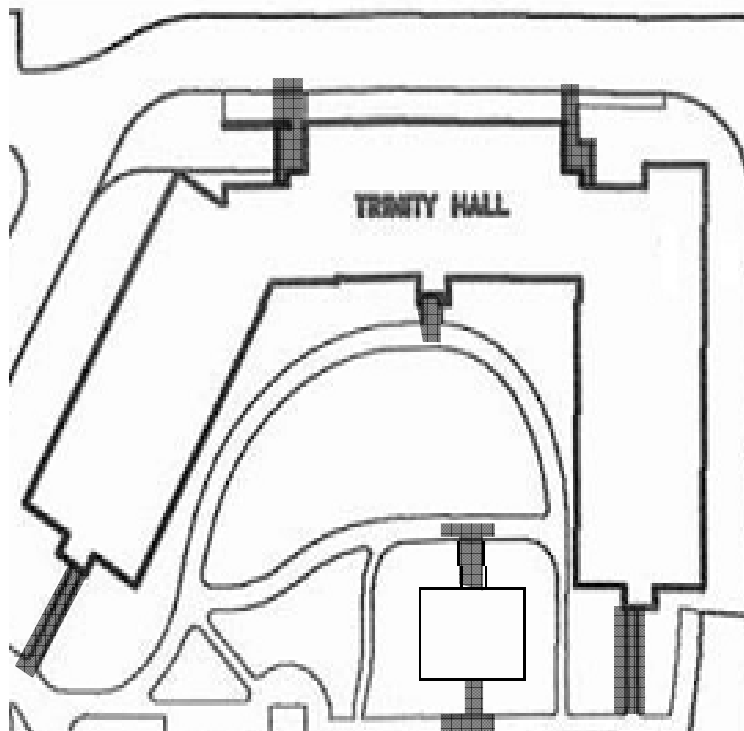

B ... Carlson Hall

Complete **BY:**

7:00 AM ■■■

****Salt interior LANDINGS, SIDEWALKS AND STAIRS as needed****

****Shovel and Salt ALL 3 FLOORS****

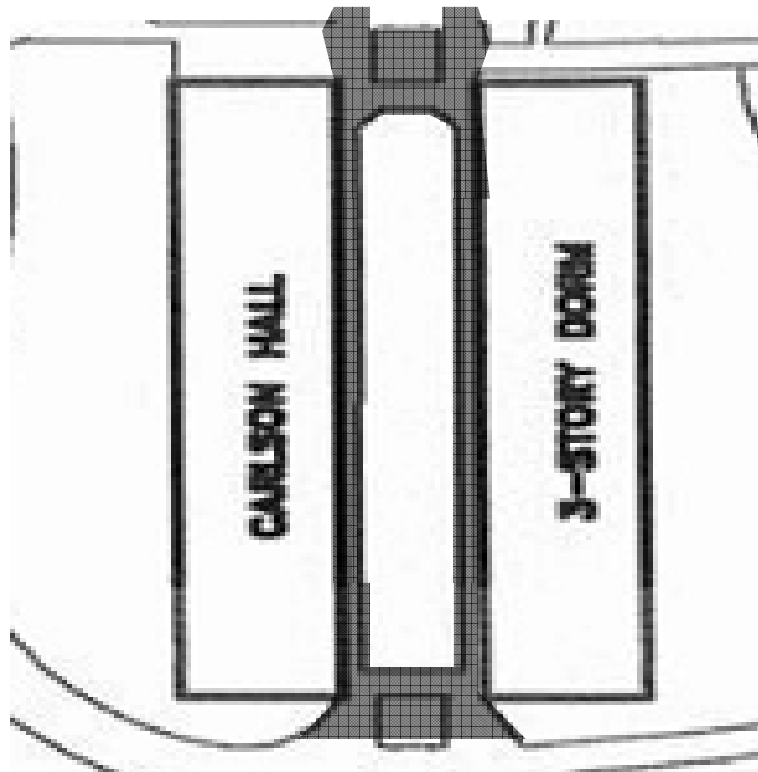

C ... Johnson Hall

Complete **BY:**

7:00 AM ■■

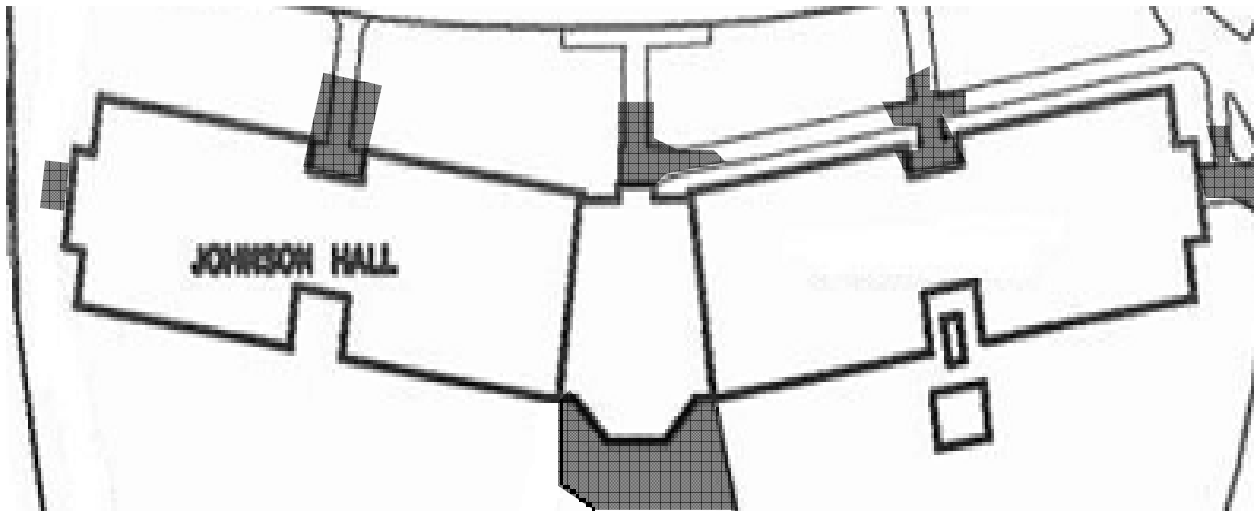

D ... Waybright

Complete BY:

6:00 AM

Be sure to get ALL stairways and loading docks on the northwest side of building, as no plow will be able to get these and they **NEED to be accessible**

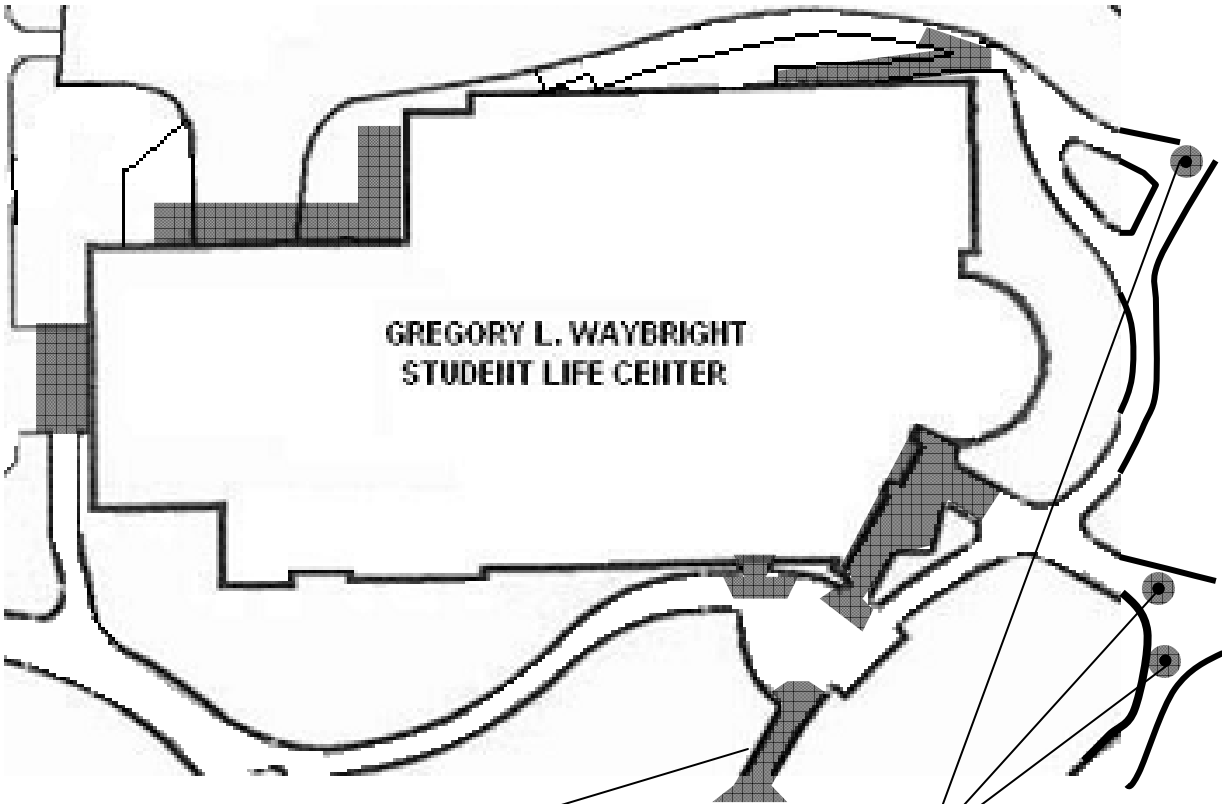

Shovel stairs and 5 feet at the top and bottom of

Shovel 2 feet around each of these 3 bollards

E ... Madsen

Complete **BY**:

7:00 AM ■■■

Salt southern flight of stairs as needed

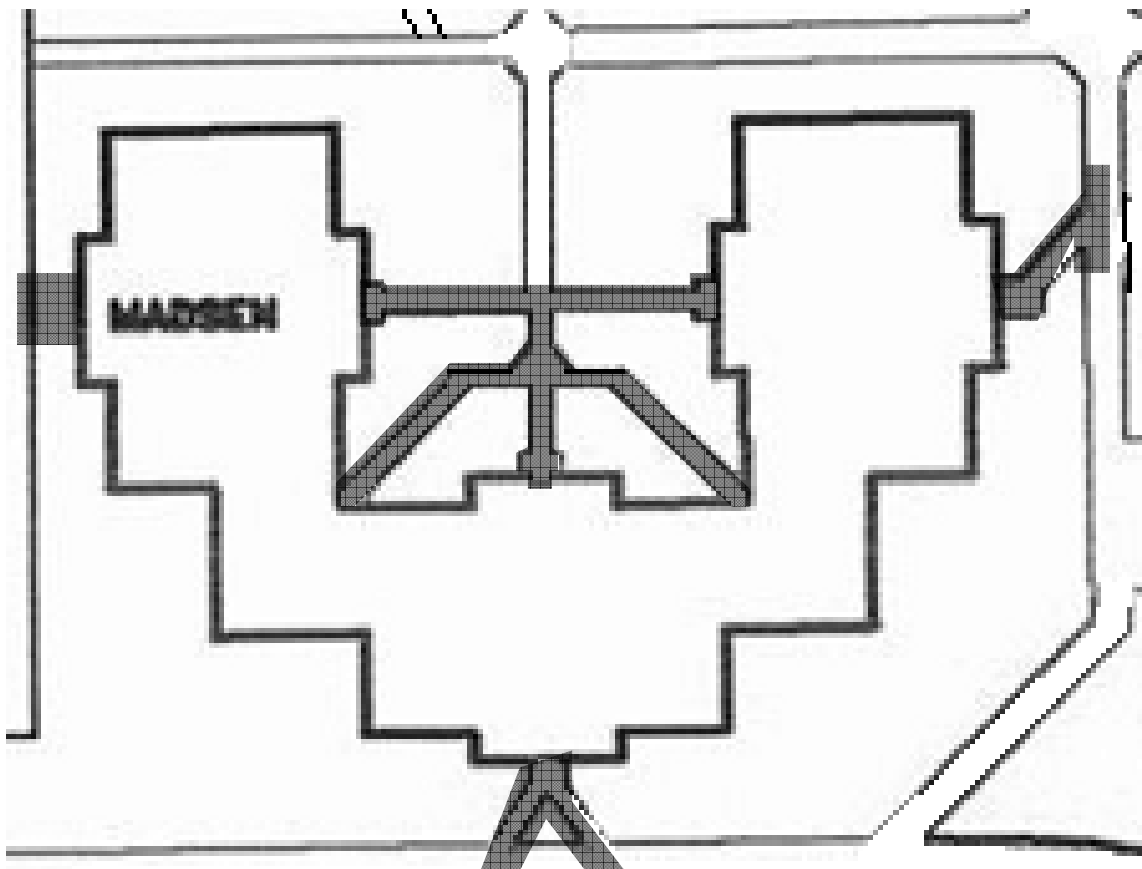

F ... Lew

Complete **BY:**

6:00 AM ■■■

****On the northern side of building be sure to extend onto wide fire sidewalk****

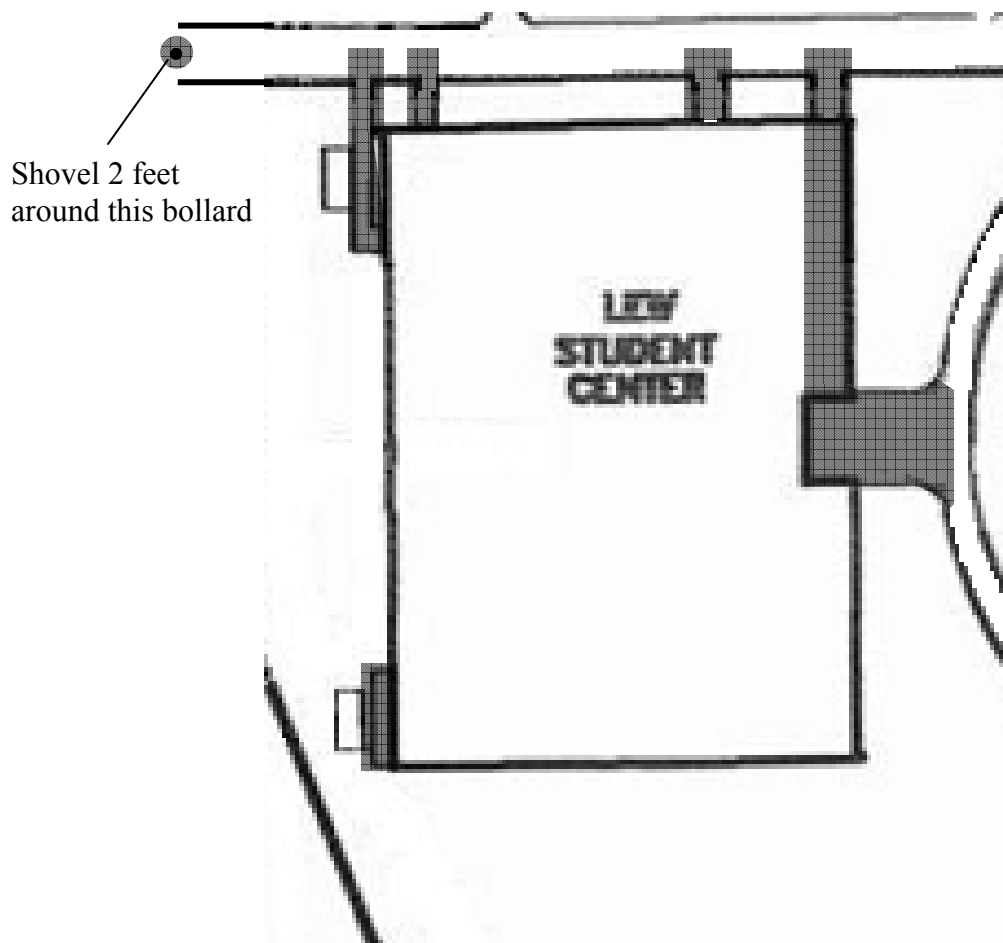

VERY IMPORTANT

Shovel emergency exit
concrete "landing" area so
door can open

G ... McLennan

Complete BY:

6:00 AM

Salt stairs as needed, *especially* south entrance to the Peterson wing

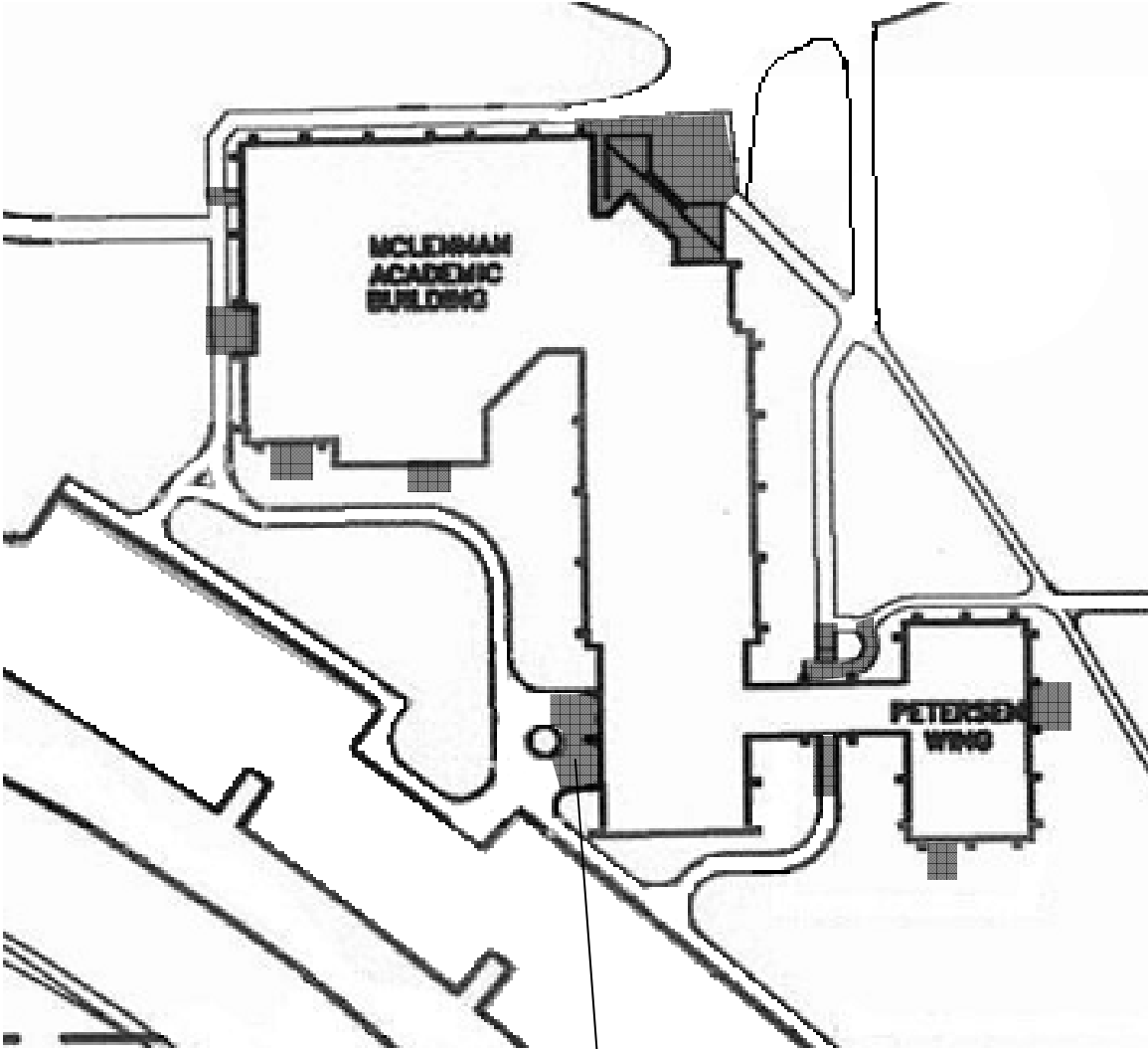

VERY IMPORTANT
Shovel emergency exit
concrete “landing” area so
door can open

Move the recycling totters/bins in
order to shovel area completely

H ... Welcome Center and Aldeen

Complete **BY:**

6:00 AM ■■■

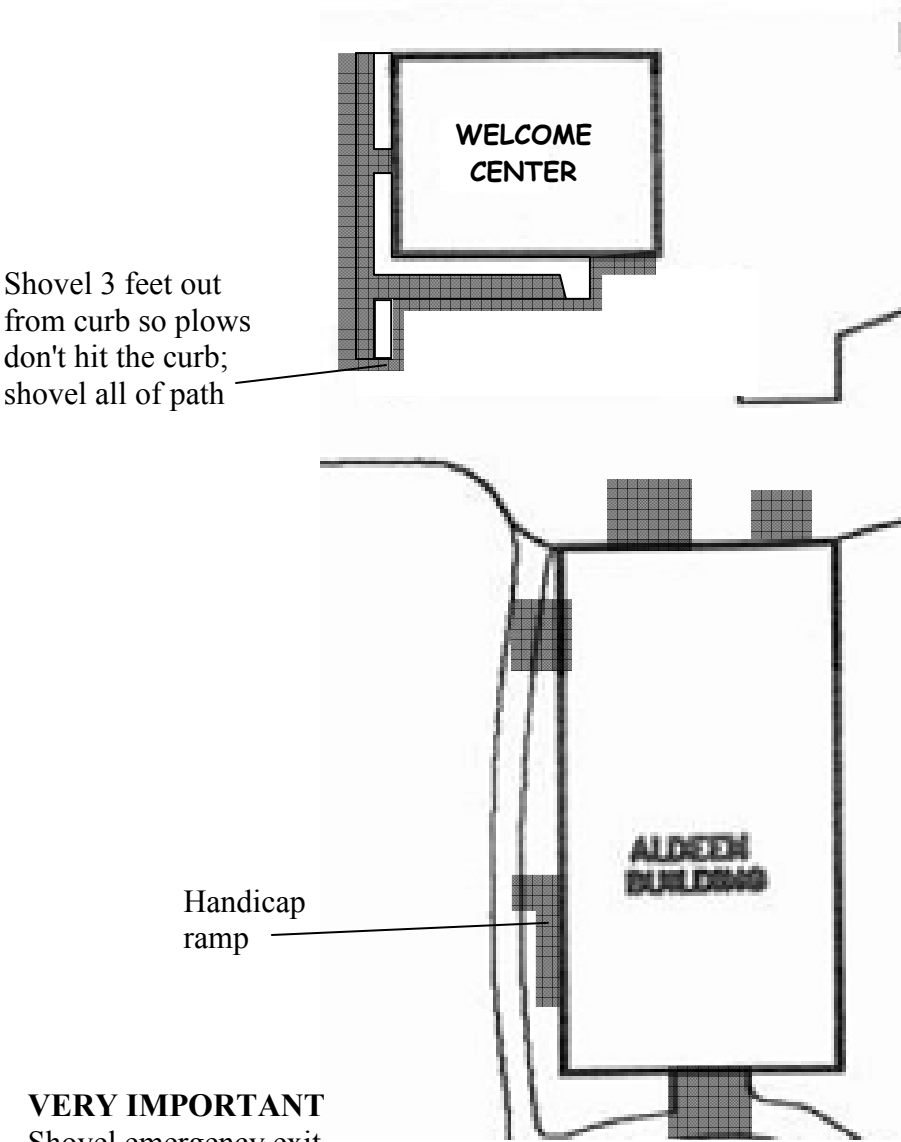

Shovel 3 feet out from curb so plows don't hit the curb; shovel all of path

Handicap ramp

VERY IMPORTANT
Shovel emergency exit concrete "landing" area so door can open

I.1 ... Apts. A, B, C

Complete **BY**:

7:00 AM ■■■

****For ALL stairwells and flights of stairs, remove ALL snow. Do not just shovel a path, shovel the whole stairwell and flight.****

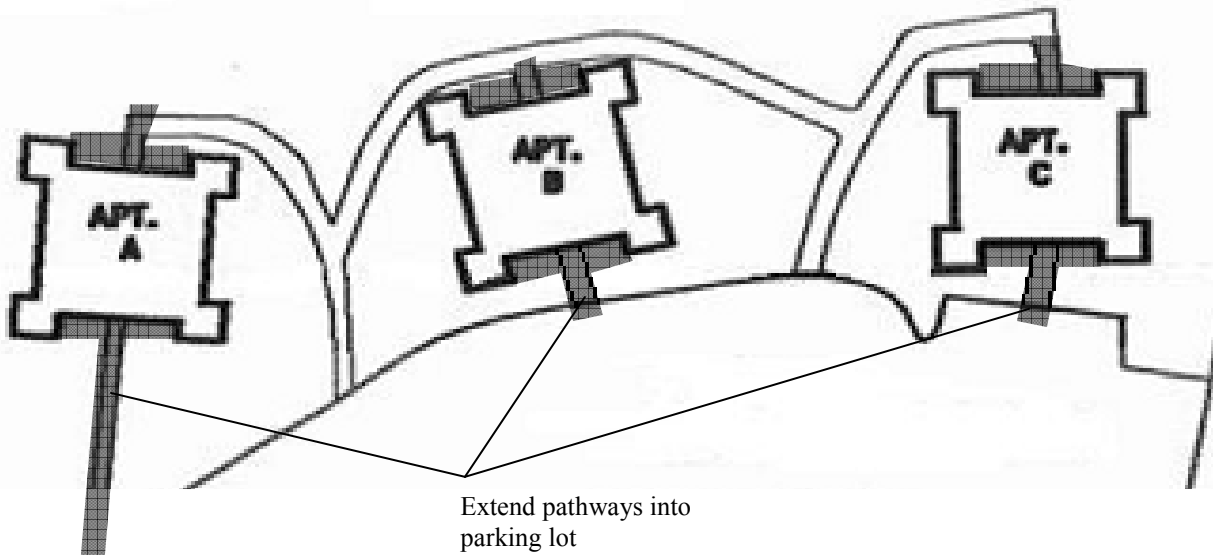

I.2 ... Apts. D, E, F

Complete **BY**:

7:00 AM ■■■

****For ALL stairwells and flights of stairs, remove ALL snow. Do not just shovel a path, shovel the whole stairwell and flight.****

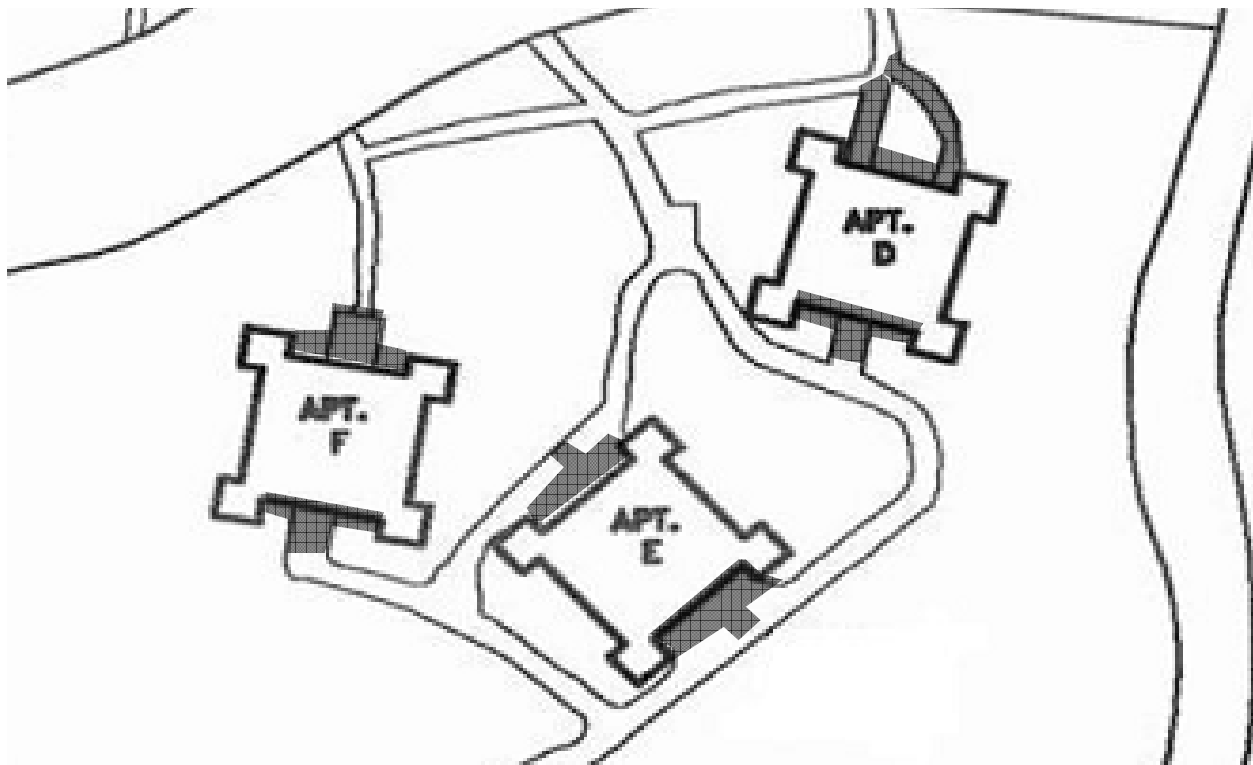

J ... Chapel and Academic Offices

Complete **BY:**

7:00 AM ■■■

Shovel **WHOLE flight of stairs on south and west side of Chapel and east side of Kanzter Wing, do not just shovel a path. Salt stairs as needed in both areas.

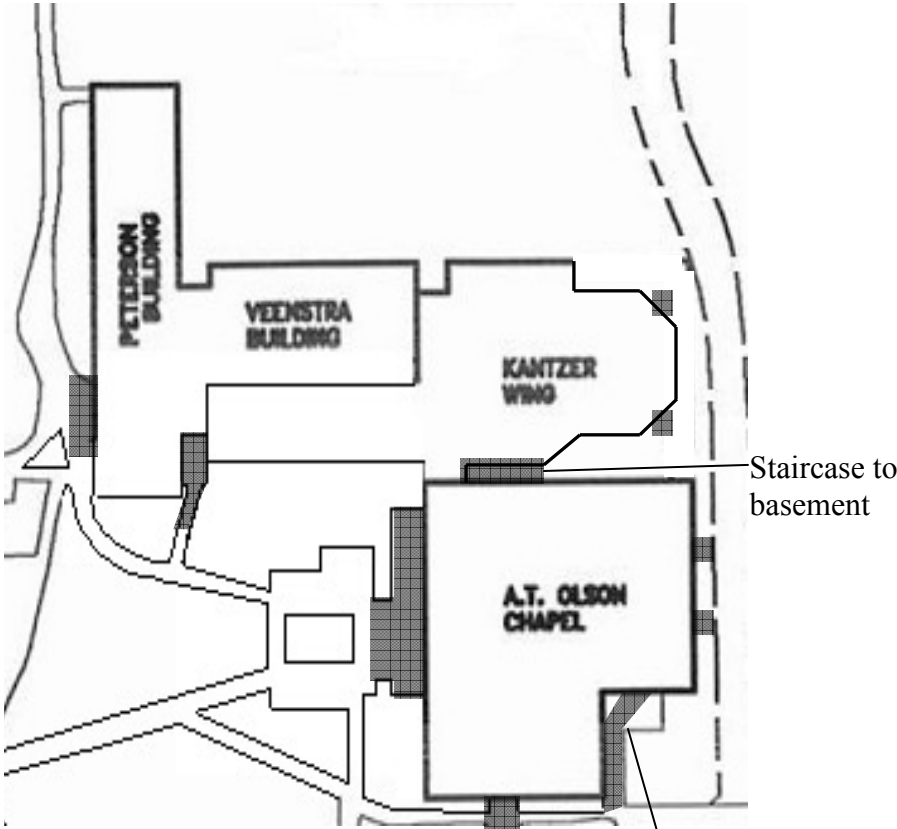

Shovel staircase in its entirety and a 4 foot path to door

VERY IMPORTANT
Shovel emergency exit concrete "landing" area so door can open

K ... Rodine, Lee, and Gunderson

Complete BY:

7:00 AM

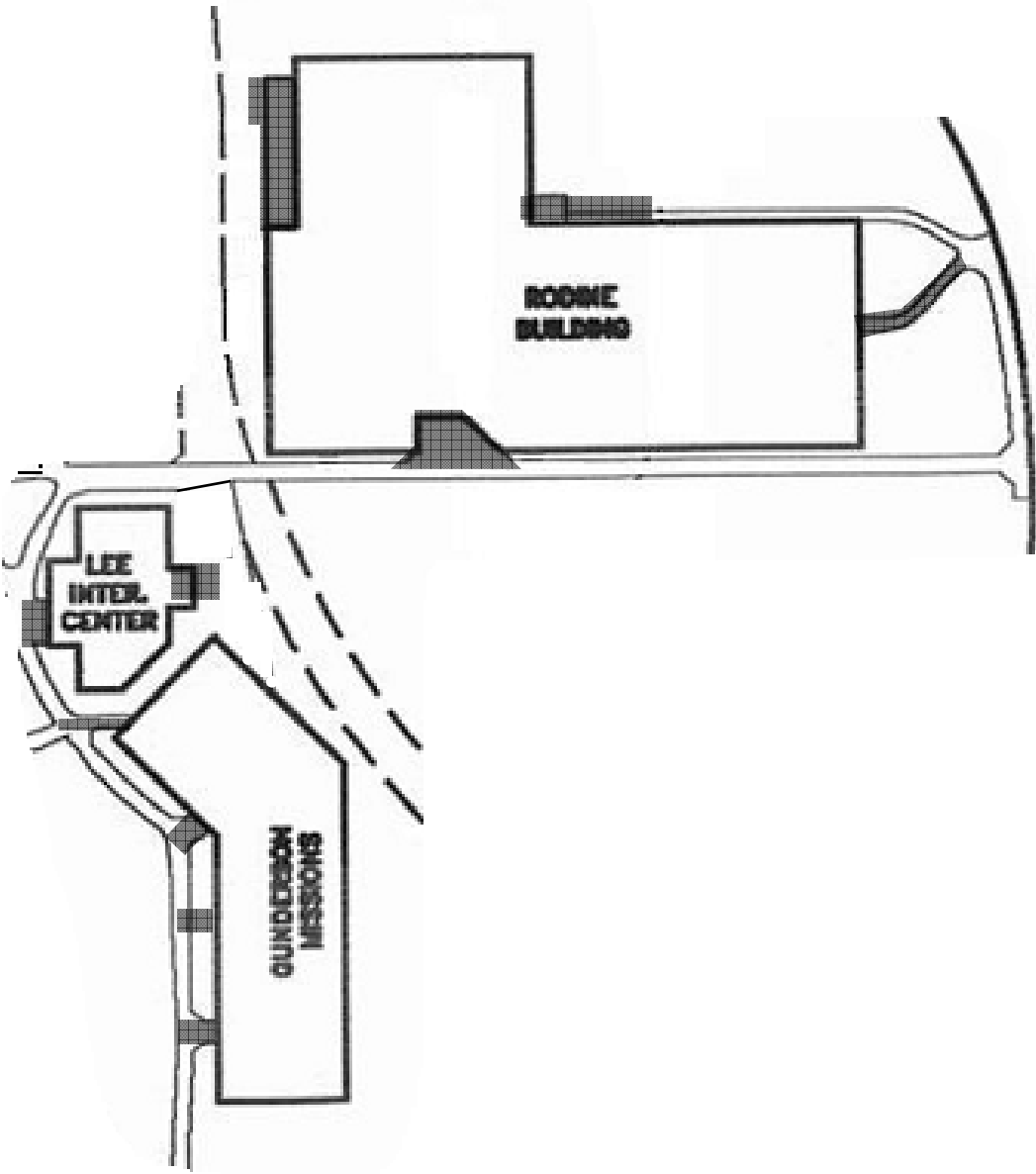

L ... Mansion, Facilities, and Rofling Library

Complete **BY:**

7:00 AM ■■■

****MANSION IS NUMBER 1 PRIORITY****

****On north east side of Mansion be sure to completely shovel the stairwell. On north west side entrances be sure to clear out both entrances to the building.****

****Shovel loading dock entirely on east side of facilities****

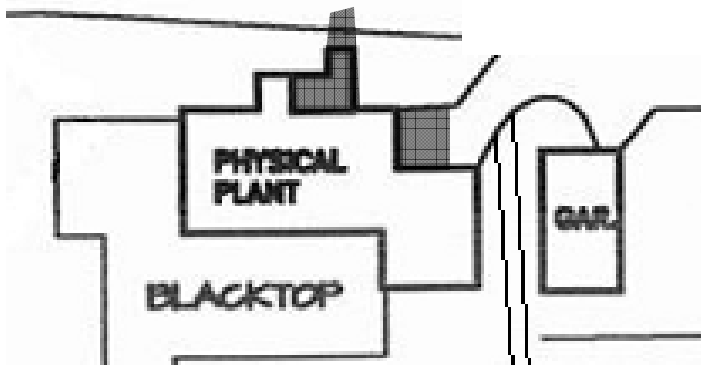
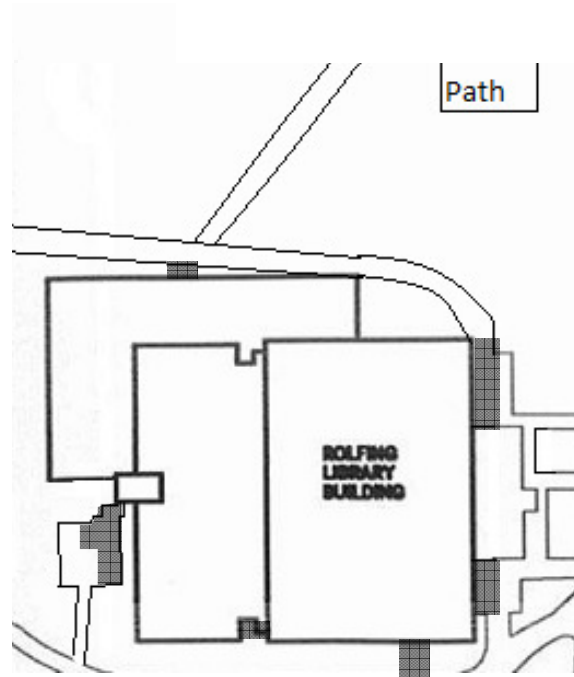
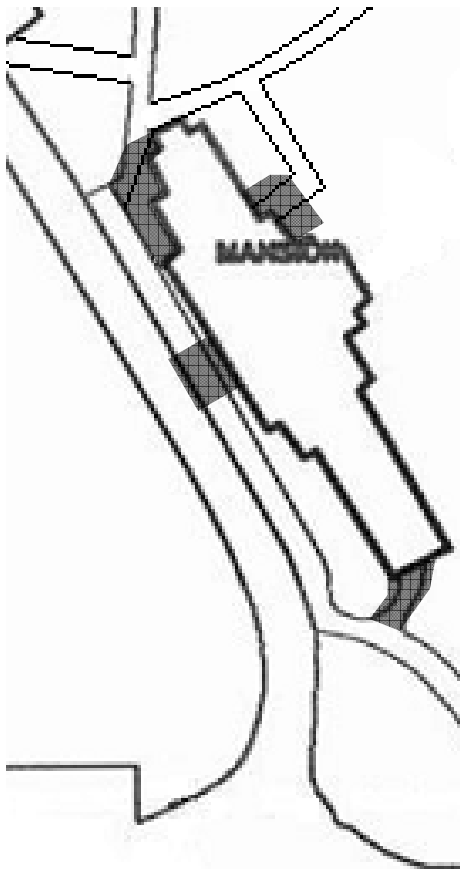

VERY IMPORTANT
Shovel emergency exit
concrete "landing" area so
door can open

M ... North, South and Ludwigson

Complete BY:

7:00 AM ■■■

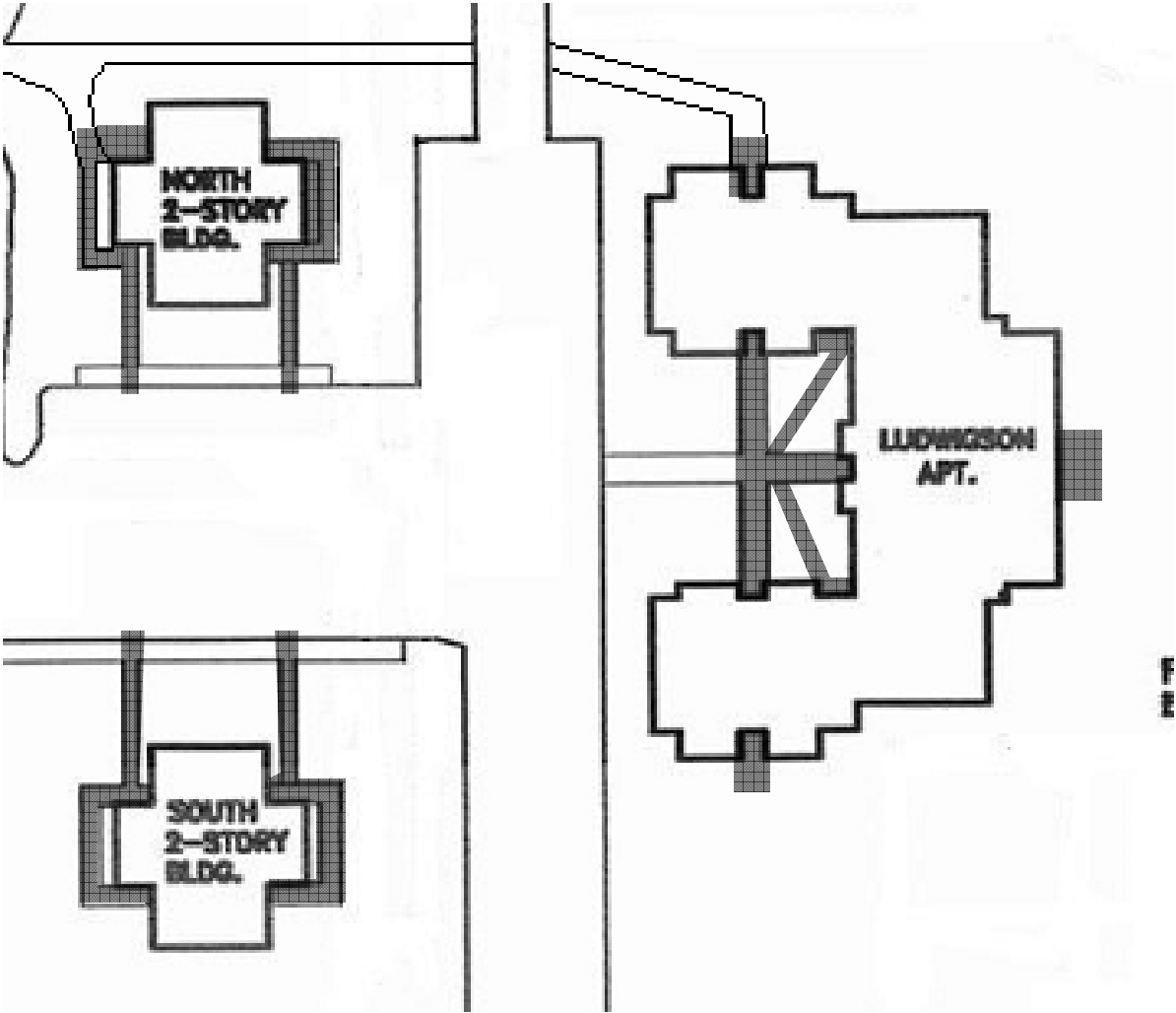

N ... Owens, Gunderson, Quads

Shovel stairs for Quad 1 and all the entrances for all the quads

Complete **BY:**

7:00 AM 

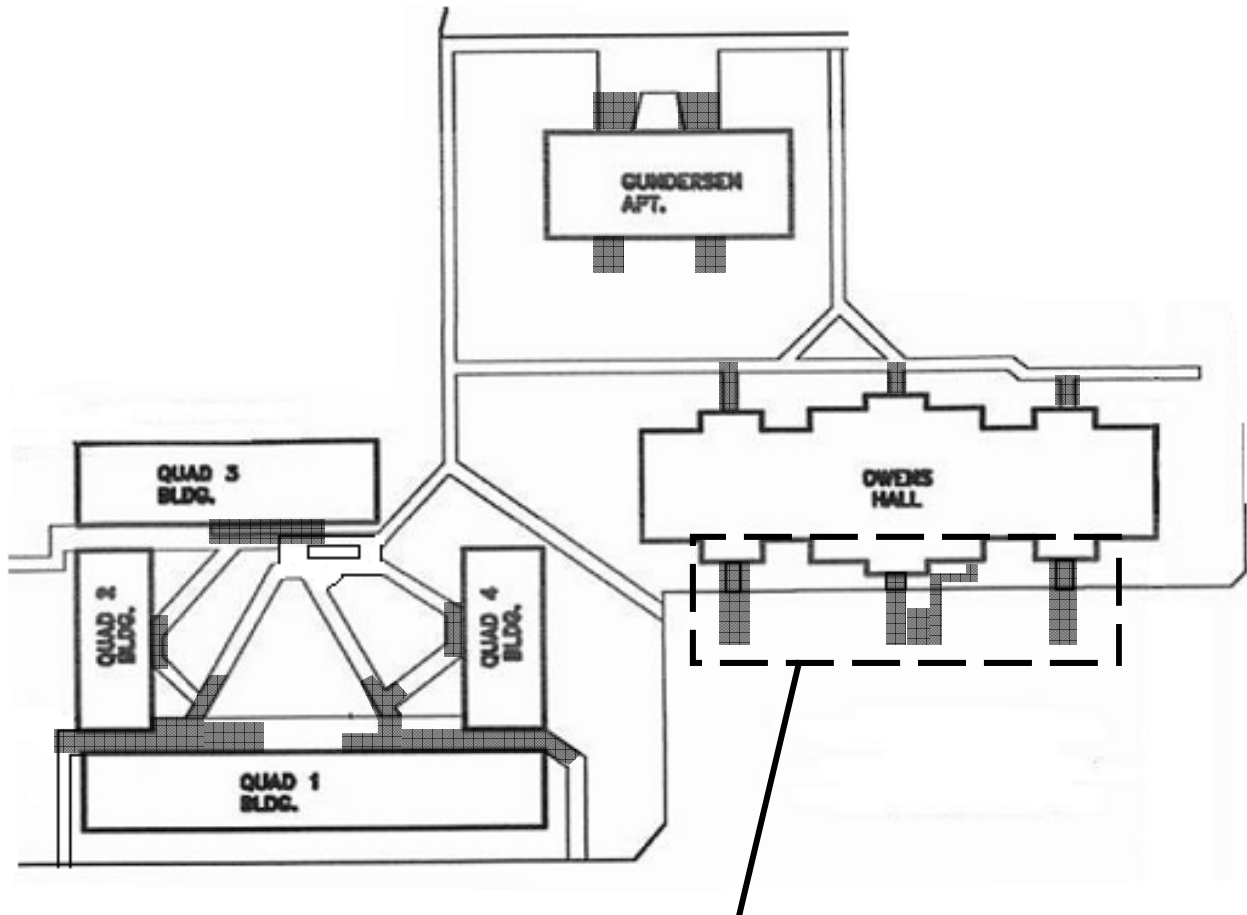

Be sure **ALL handicap areas and boxes with a yellow X are **COM-
PLETELY** shoveled out to pavement**

O ... Kenneth Meyer

Complete **BY:**

7:00 AM ■■■

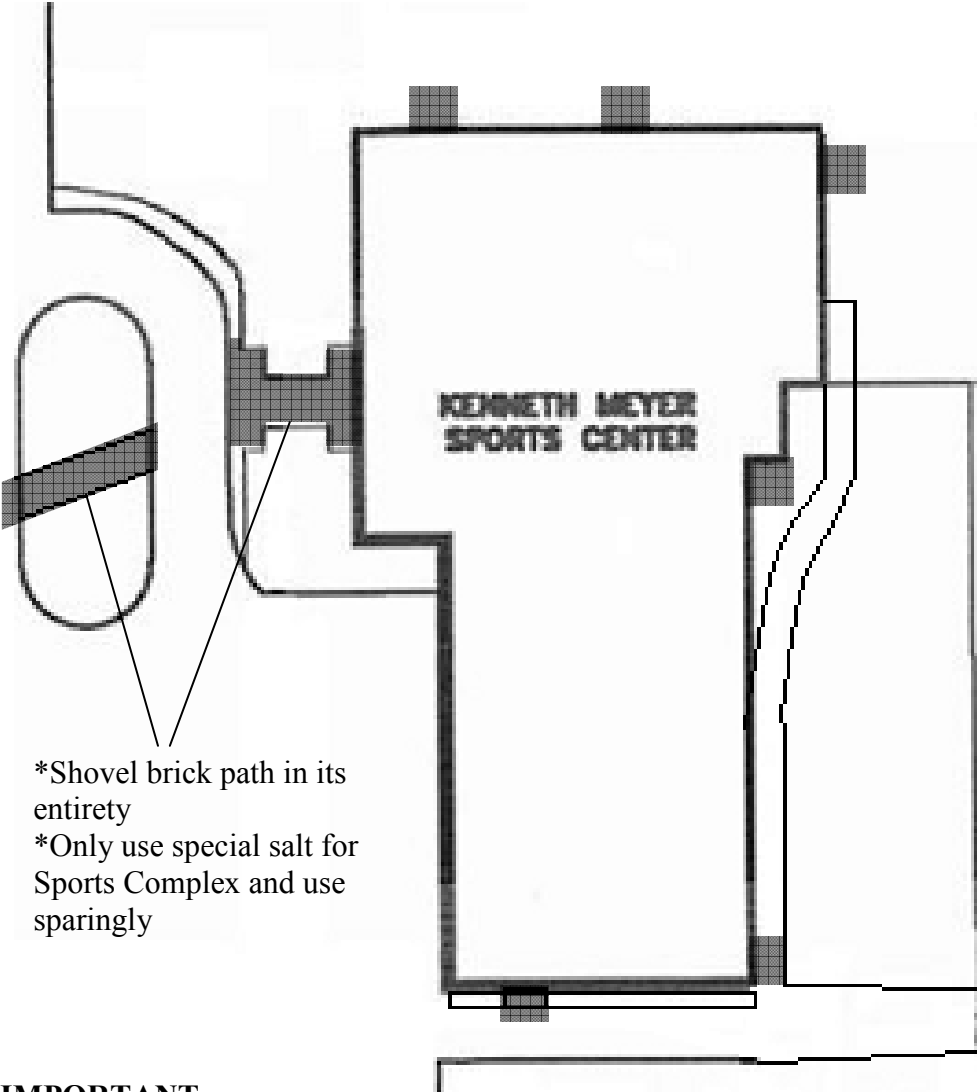

VERY IMPORTANT
Shovel emergency exit
concrete “landing” area so
door can open